

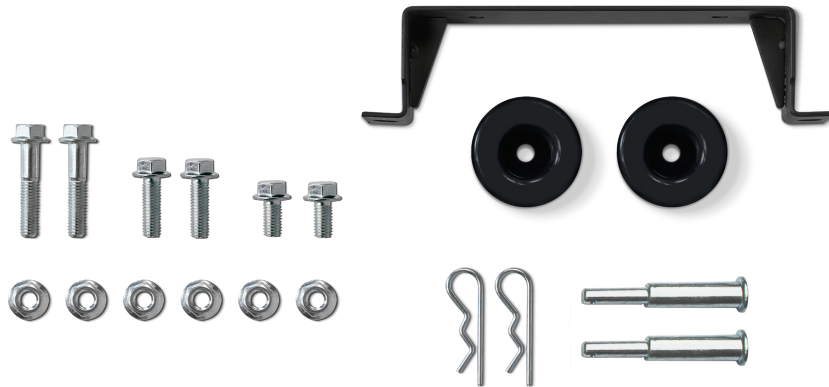

REGISTER YOUR PRODUCT ONLINE

at [www.championpowerequipment.co.uk](http://www.championpowerequipment.co.uk)



## Parts Included

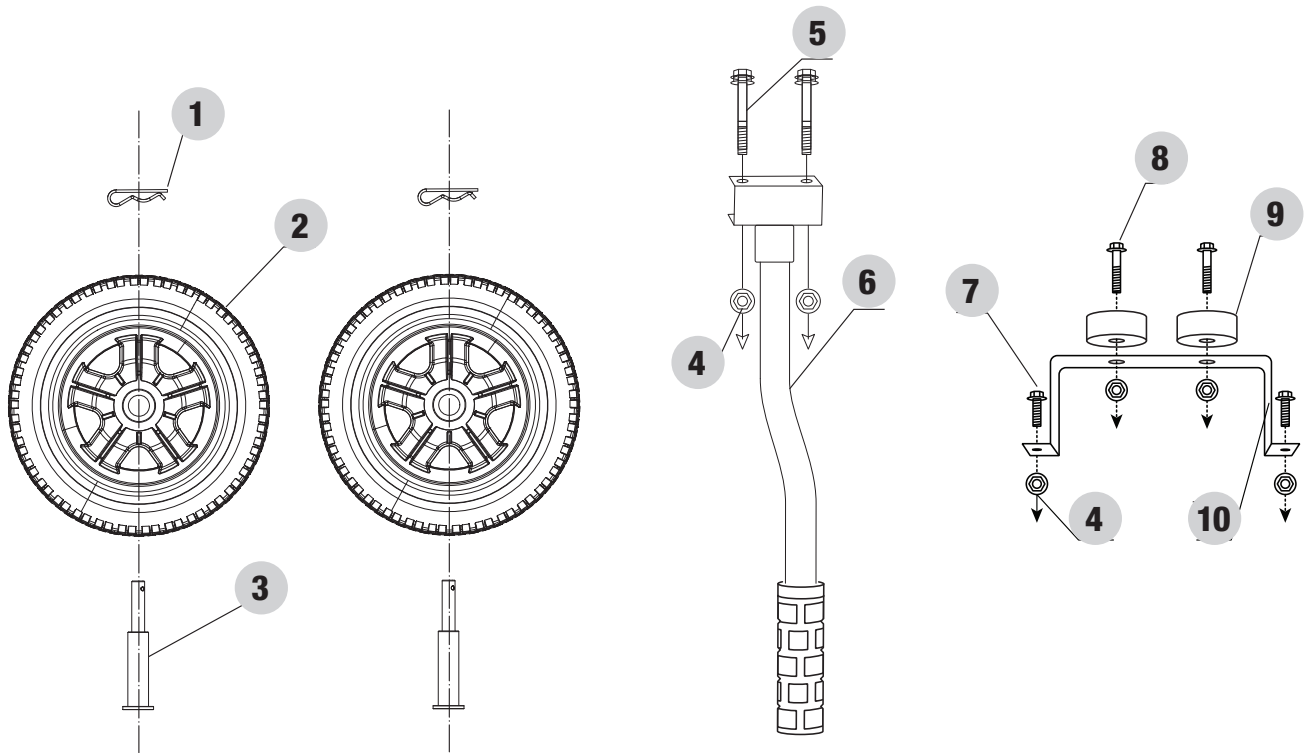

#	Part Number	Description	Qty.
1	2.16.001	R-Pin	2
2	122.201701.07.2	Wheel, Black	2
3	122.201501.23	Pin Roll, Wheel	2
4	1.6177.1.08	Lock Nut M8 Flange	6
5	1.5789.0845	Flange Bolt M8 x 45	2
6	122.200700.03.2	Handle Assembly	1
7	1.5789.0816	Flange Bolt M8 x 16	2
8	1.5789.0825	Flange Bolt M8 x 25	2
9	152.201400.00	Rubber Support	2
10	152.200002.00	Support Leg	1

## ASSEMBLY

### ⚠ CAUTION

The wheel kit is not intended for over-the-road use.

### Install the Wheels

1. Drain oil and fuel, and then tip the generator slowly so that the engine side is up.
2. Slide the wheel pin roll through the wheel from the outside. (A)
3. Slide the wheel pin roll through the mount point on the frame. (B)
4. Secure with the R-Pin. (C)
5. Repeat steps 2-4 to attach the second wheel.

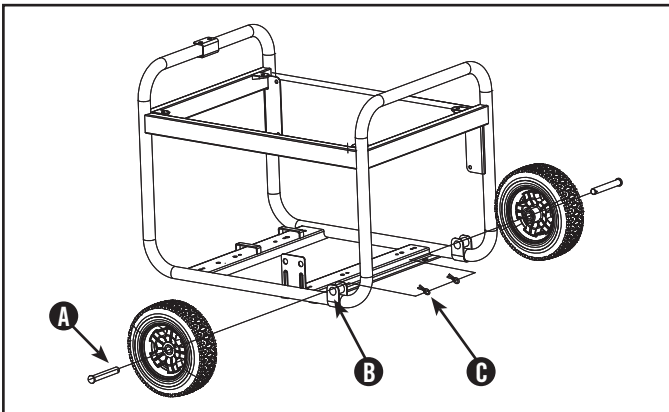

You will need the following tools to install the leg support and handle:

- 12mm wrench or adjustable wrench (not included)
- Socket wrench with a 12mm socket (not included)

### Install the support leg

1. Attach the rubber vibration mounts to the support leg with a flange bolt M8 x 25 and flange lock nuts.
2. Attach the support leg to the generator frame with flange bolts M8 x 16 and flange lock nuts and fasten securely. DO NOT over tighten the lock nuts. (D)
3. Tip the generator slowly so that it rests on the wheels and support leg.

### 🗨 NOTICE

Some generator models will require removing rubber pads prior to installing the support leg. The support leg will use the same holes as the rubber pads.

### Install the handle

1. Place the handle over the mounting channel on the frame.
2. Secure the handle to the frame using the two handle bolts.
3. Place a lock nut on the end of each bolt and fasten securely. DO NOT over tighten the lock nuts. (E)

